

ANTARES AM4400



Benefits

- Offers a good performance from a square reflector distribution, with the option of an asymmetric beam using an internal shield to prevent light overspill
- Low light pollution 2% ULOR

Features

- Injection moulded polycarbonate clear lower bowl fitted to aluminium top cover, finished with black or white polyester powder coating
- Hydro-formed aluminium reflector system providing efficient square light distribution
- High-pressure die cast aluminium spigot attachment carrying integral control gear (where applicable)
- Two size options – large sphere or small sphere
- Available with integral and remote gear
- Compatible with a range of columns up to 8m

Applications

- Parks and gardens
- Pedestrian areas
- Retail and leisure car parks
- Large area
- General car parks

Lighting distribution

- Square
- Asymmetric (utilising optional internal shield), available on AM4401/02 only

Colours

- RAL9005 Black (standard)
- RAL9016 White Gloss

White Gloss is available on request and at extra cost.

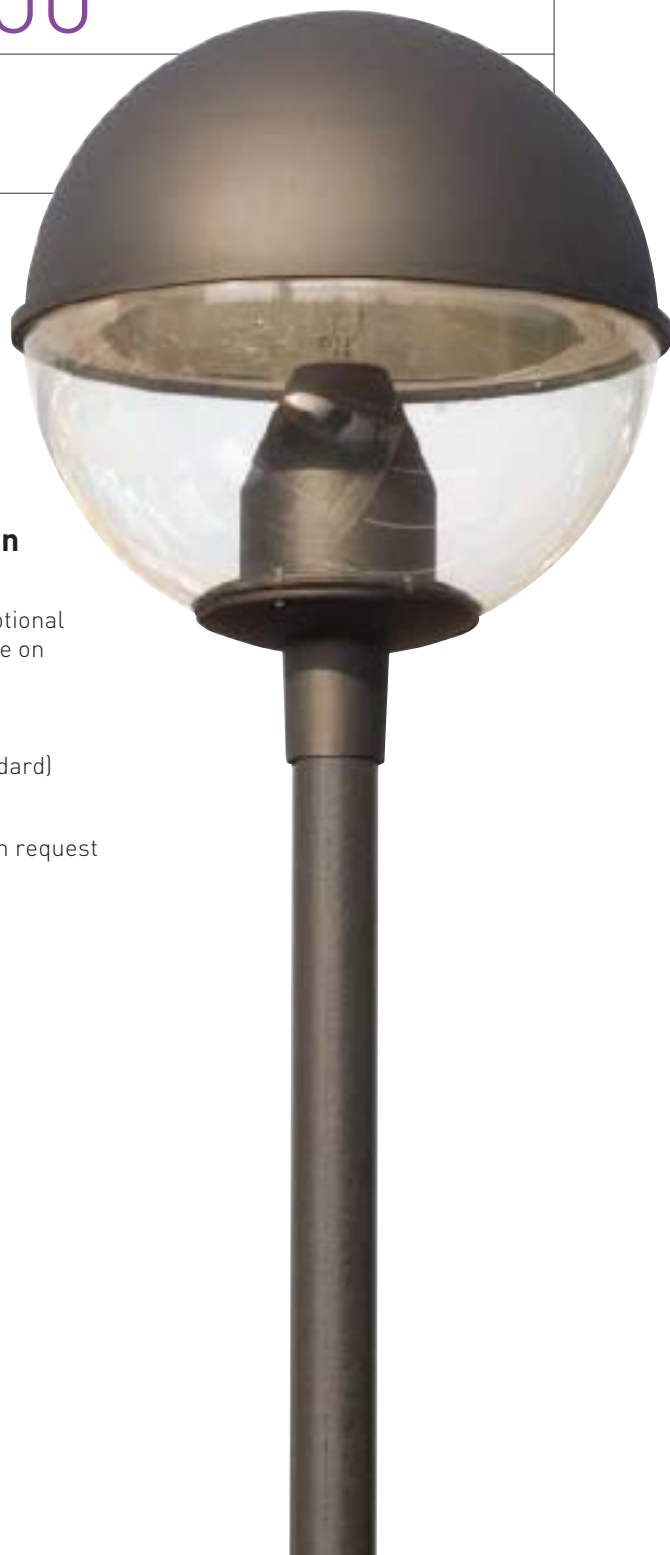

	Lamp wattage and type	Lamp holder	Description	Weight (Kg)*	Windage (m ²)*
AM4401	100/150/250W SON-T 250W HQI-T	E40	Large sphere integral gear	12.6	0.282
AM4402	100/150/250/400W SON-T 250/400W HQI-T	E40	Large sphere loose gear	8.7	0.282
AM4403	70W SON-T 70/100/150W HQI-E	E27	Small sphere integral gear	9.5	0.241
AM4404	100/150W SON-T	E40	Small sphere loose gear	9.7	0.241

*Max in range.



Column options

Choose between fixed and base hinged

	8m	6m	5m
Fixed	TB08.SP1	TB060	TB050
Base	T081RLS.SP1	T061RLS	T051RLS

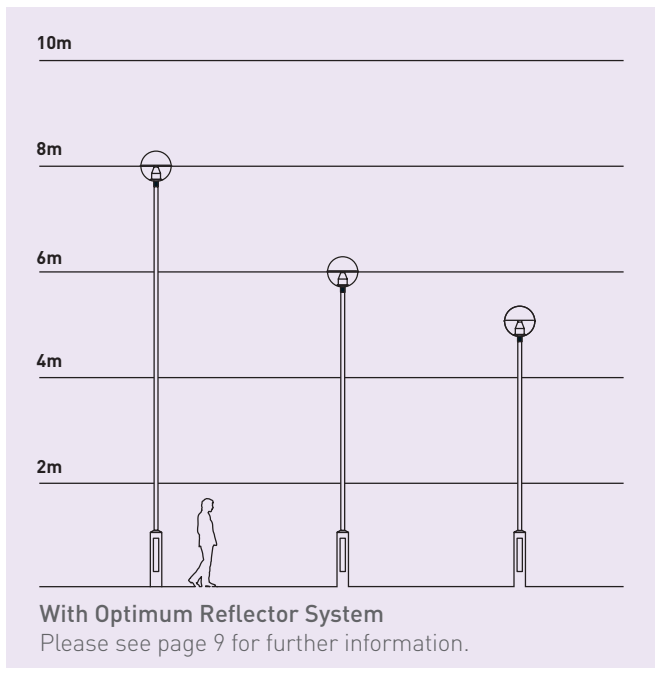

Spotlight on Antares

PROJECT:

Car park lighting was integral to this community sport area funded by Barclays. The project specification required a safe and securely lit environment for visitors at night.

LOCATION:

South Bristol, England

PRODUCTS:

Antares AM4400

BENEFITS:

Low level mounting height ensured minimal visual intrusion whilst providing a uniformly well lit car park.

RESULTS:

“We chose Abacus because they have an excellent reputation for project management, clarity of design and commercial awareness. We found them to be particularly helpful, especially during the planning stage.”

Mark Jeffrey Director AP Thompson

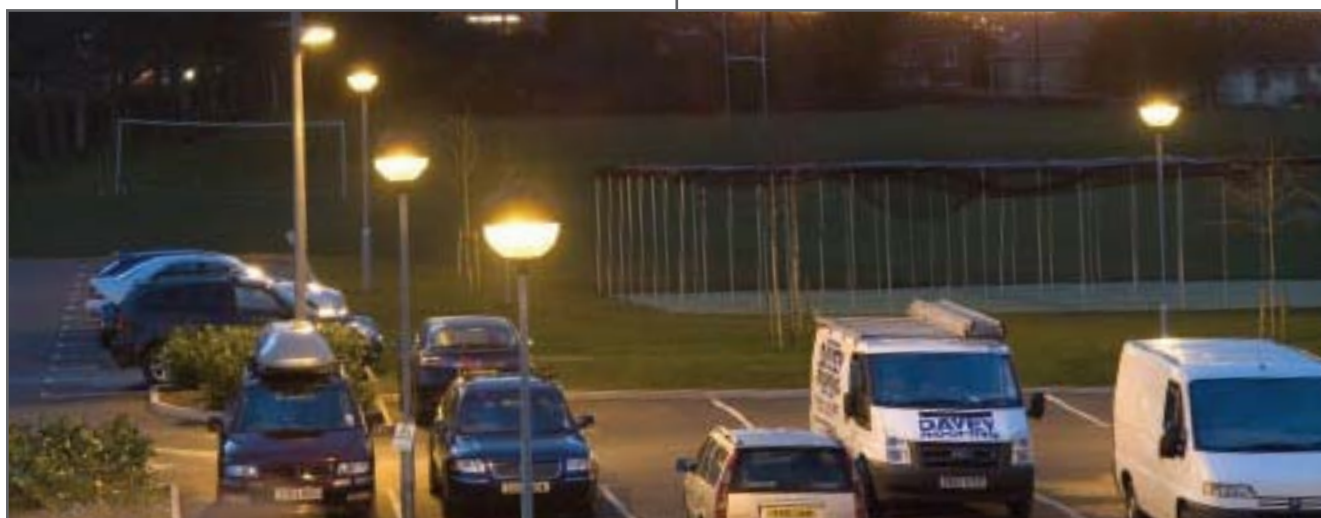

Key features

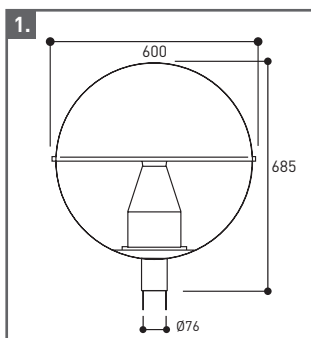

Dimensions & Mounting
Large sphere, AM4401/2
Mounting height: 4m – 8m

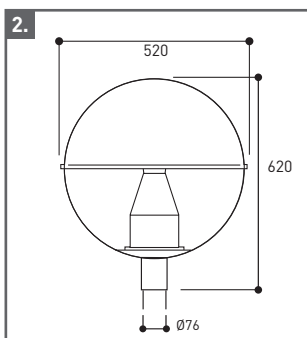

Dimensions & Mounting
Small sphere, AM4403/4
Mounting height: 4m – 8m

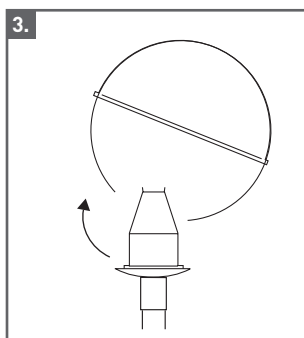

Maintenance
Release three screw fixings and lift sphere for quick and easy lamp change

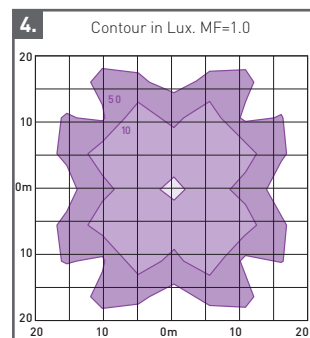

Square distribution
Lamp 250W SON-T
Mounting height: 8m

All dimensions are in mm.