

# CONCEPT® CLASSIC AL8010



## Benefits

- High performance and versatility
- End of life refurbishment

## Features

- Aluminium canopy and trim finished in durable, polyester powder coating
- Die-cast aluminium central chassis designed to accept multiple bracket options
- Highly polished, anodised aluminium reflector
- GRP decorative bezel finished in silver
- Polycarbonate teardrop bowl
- Offered with the 8m, 6m and 5m height Classic contemporary column

- Electronic control gear up to 150W
- Central chassis module sealed to IP65
- Accepts up to 250W metal halide or high pressure sodium lamps
- Integral control gear to 150W (excluding 50° variable beam)

## Colours

- RAL9005 Black
- RAL6005 Moss Green

Note: option to select gold colour on upper canopy



Classic Swan Neck  
SN/76 or 89



Classic Yoke  
CY/76 or 89



Classic Wall Mount  
CWM/XX  
L = 400-600mm

L = Distance from column to centre of lantern

## Classic canopy

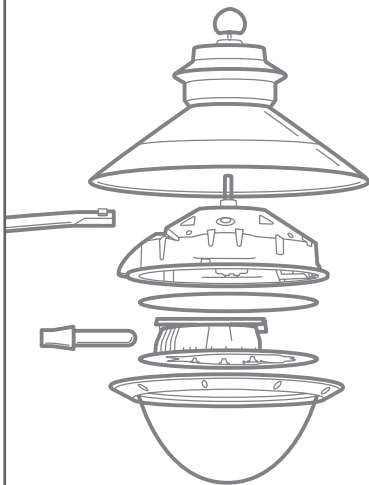

### Classic exploded view

The Concept® Classic lantern comprises a canopy, reflector and bezel with polycarbonate tear bowl. Different canopies can be fitted to adapt to changing styles thanks to the chassis construction. The redundant parts can be recycled or reused.

## Variable Beam Reflector



### Variable Beam Reflector

The innovative, patented Variable Beam Reflector is at the heart of the success of the Concept lantern. Its unique design incorporates a series of highly polished and anodised reflector segments; these can be positioned in a variety of positions to deliver four beam options for optimum lighting results across a range of applications.

- 5° axial or elongated lighting distribution ideal for pathways
- 15° road lighting distribution
- 30° oblong light distribution or square distribution when mounted in a twin lantern arrangement
- 50° forward throw to light wide areas

	Lamp wattage and type	Lamp holder	Description	Weight (Kg)*	Windage (m <sup>2</sup> )
AL8011	70/100/150/250W SON/HQI	E27/E40	Swan neck or wall mounted bracket Variable Beam Reflector	16.12	0.23
AL8012	70/100/150/250W SON/HQI	E27/E40	Classic yoke bracket Variable Beam Reflector	16.12	0.23

\*Max in range.



## Column and bracket options

Choose between fixed and base hinged

	8m	6m	5m		8m	6m	5m
Fixed	TB081/CLASSIC	TB060/CLASSIC	TB050/CLASSIC	Base diameter (mm) Shaft diameter (mm) Base height (mm) Flange plate Root length (mm) Door opening (mm) Cable entry (root) (mm)	168	140/168	140/168
Base	T081RLS	T061RLS	T051RLS				
Yoke	CY/89	CY/76	CY/76				
Swan neck	SN/89	SN/76	SN/76				
Wall	-	-	CWM/XX				
Accessories							
ELS955/8	Single phase, cut-out, 6A, termination plate			Classic Base-hinged			
ELS955/9	Twin fuse cut-out, 6A, termination plate						
AL8010PC	Photocell option, miniature, two part up to 150W						
Columns and brackets finished hot dip galvanised then spray painted with 2-pack acrylic coat. Wet finish 190 microns.							



## Key features

<p><b>1.</b></p>	<p><b>2.</b></p>	<p><b>3.</b> Contour in Lux. MF=1.0</p>	<p><b>4.</b> Contour in Lux. MF=1.0</p>	<p><b>5.</b> Contour in Lux. MF=1.0</p>	<p><b>6.</b> Contour in Lux. MF=1.0</p>
<p><b>Dimensions &amp; Mounting</b> All bracket options offered with an outreach of 500mm – 1000mm</p>	<p><b>Maintenance</b> Access the lamp and control gear by lowering the bezel (secured by ¼ turn fasteners)</p>	<p><b>5° Single Concept® Lantern</b> 150W SON-PT Mounting height: 8m</p>	<p><b>15° Single Concept® Lantern</b> 150W SON-PT Mounting height: 8m</p>	<p><b>30° Single Concept® Lantern</b> 150W SON-PT Mounting height: 8m</p>	<p><b>50° Single Concept® Lantern</b> 150W SON-PT Mounting height: 8m</p>

All dimensions are in mm.