

CONCEPT® RETRO AL8020



Benefits

- High performance and versatility
- 0% ULOR with the flat glass option
- End of life refurbishment

Features

- Aluminium canopy and trim finished in durable, polyester powder coating
- Die-cast aluminium central chassis designed to accept multiple bracket options
- Highly polished, anodised aluminium reflector
- GRP decorative bezel finished in silver
- Polycarbonate bowl with low profile styling or flat glass version for low light pollution applications

- Offered with the 8m, 6m and 5m height High Cone contemporary column
- Electronic control gear up to 150W
- Central chassis module sealed to IP65
- Accepts up to 250W metal halide or high pressure sodium lamps
- Integral control gear to 150W (excluding 50° variable beam)

Colours

- RAL9005 Black
- RAL9007 Gunmetal
- RAL9006 Silver
- RAL9003 White
- RAL3020 Red
- Interpon 610 Blue



Retro Swan Neck
SN/76 or 89



Retro Single Arm
CHC/S/XX/76 or 89
L = 300-1000mm



Retro Twin Arm
CON/D/XX/76 or 89
L = 400-1000mm



Retro Wall
RWM/XX
L = 400-800mm

L = Distance from column to centre of lantern

Retro canopy

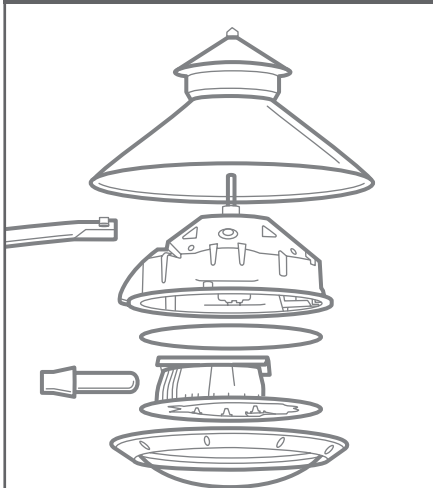

Retro exploded view

The Concept® Retro lantern comprises a canopy, reflector and bezel with flat glass or low profile bowl. Different canopies can be fitted to adapt to changing styles thanks to the chassis construction. The redundant parts can be recycled or reused.

Variable Beam Reflector



Variable Beam Reflector

The innovative, patented Variable Beam Reflector is at the heart of the success of the Concept lantern. Its unique design incorporates a series of highly polished and anodised reflector segments; these can be positioned in a variety of positions to deliver four beam options for optimum lighting results across a range of applications.

- 5° axial or elongated lighting distribution ideal for pathways
- 15° road lighting distribution
- 30° oblong light distribution or square distribution when mounted in a twin lantern arrangement
- 50° forward throw to light wide areas

	Lamp wattage and type	Lamp holder	Description	Weight [Kg]*	Windage [m²]
AL8021	70/100/150/250W SON/HQI	E27/E40	Low profile bowl Variable Beam Reflector	15.61	0.13
AL8022	70/100/150/250W SON/HQI	E27/E40	Flat glass Variable Beam Reflector	15.61	0.13

*Max in range.



Column and bracket options

Choose between fixed and base hinged

	8m	6m	5m		8m	6m	5m	
Fixed	TB081/Hi-CONE/R	TB060/Hi-CONE/R	TB050/Hi-CONE/R	 				
Base	T081RLS	T061RLS	T051RLS		Base diameter (mm)	168	140/168	140/168
Swan neck	SN/89	SN/76	SN/76		Shaft diameter (mm)	89	76	76
Single	CHC/S/XX/89	CHC/S/XX/76	CHC/S/XX/76		Base height (mm)	1250	1250	1250
Twin	CON/D/XX/89	CON/D/XX/76	CON/D/XX/76		Flange plate	Type 1	Type 0	Type 0
Wall	-	-	RWM/XX		Root length (mm)	1200	1000	800
Accessories					Door opening (mm)	600 x 115	500 x 100	500 x 100
ELS955/8	Single phase, cut-out, 6A, termination plate				Cable entry (root) (mm)	150 x 50	150 x 50	150 x 50
ELS955/9	Twin fuse cut-out, 6A, termination plate							
AL8020PC	Photocell option, miniature, two part up to 150W							

Columns and brackets finished hot dip galvanised then spray painted with 2-pack acrylic coat. Wet finish 190 microns.



Key features

<p>1.</p>	<p>2.</p>	<p>3.</p>	<p>4.</p>	<p>5.</p>	<p>6.</p>
<p>Dimensions & Mounting Mounting height: 5m – 8m</p>	<p>Maintenance Access the lamp and control gear by lowering the bezel (secured by ¼ turn fasteners)</p>	<p>5° Single Concept® Lantern 150W SON-PT Mounting height: 8m</p>	<p>15° Single Concept® Lantern 150W SON-PT Mounting height: 8m</p>	<p>30° Single Concept® Lantern 150W SON-PT Mounting height: 8m</p>	<p>50° Single Concept® Lantern 150W SON-PT Mounting height: 8m</p>

All dimensions are in mm.