

LUNA AM270



IP55



Benefits

- High performance optics with flat glass producing zero upward light

Features

- Die-cast aluminium lantern frame with spun aluminium top canopy. Finished polyester powder coated black
- Flat glass produces zero upward light
- Hinged reflector assembly, incorporating the control gear
- Precise optical control using a road lantern reflector
- Hydroformed and anodised aluminium reflector
- Available with post top, wall or twin mounting options

Colours

- RAL9005 Black (standard)
- RAL9016 Gloss White (optional)

	Lamp wattage and type	Lamp holder	Description	Weight (Kg)*	Windage (m ²)
AL273	70W SON-T	E27	Flat glass; integral gear	5.3	0.09
	70/100W HQI-E	E27	Flat glass; integral gear	5.3	0.09
AL274	100/150W SON-T	E40	Flat glass; integral gear	5.5	0.09

*Max in range.



Column and bracket options

Choose between fixed and base hinged

	6m	5m	4m		6m	5m	4m
Fixed				Base diameter (mm) Shaft diameter (60mm spigot) Base height (mm) Flange plate (mm) Root length (mm) Door opening (mm) Cable entry (root) (mm)			
Tubular	TB060/SP1	TB050/SP1	TB040		140	140	140
Hi-cone	TB060/HC	TB050/HC	TB040/HC		76	76	60/76
Hi-cone (Black)	TB060/HC/SP9005	TB050/HC/SP9005	TB040/HC/SP9005		1250	1250	1250
Base					Type 0	Type 0	Type 0
Light duty	T051RLS/SP1	T061RLS/SP1	T041RLS/SP1		1000	800	600
Light duty (Black)	T051RLS/SP1/2P9005	T061RLS/SP1/2P9005	T041RLS/SP1/2P9005		500 x 100	500 x 100	500 x 100
Brackets	White	Galv. Finish	Black		150 x 50	150 x 50	150 x 50
Post top	PR-01/S/60/2P9016	PR1-01/S/60	PR1-01/S/60/2P9005				
Twin	PR1-01/D/60/2P9016	PR1-01/D/60	PR1-01/D/60/2P9005				
Wall	WB/01/60/ODC2P9005	WB/01/60/0DC	WB/01/60/ODC2P9005				

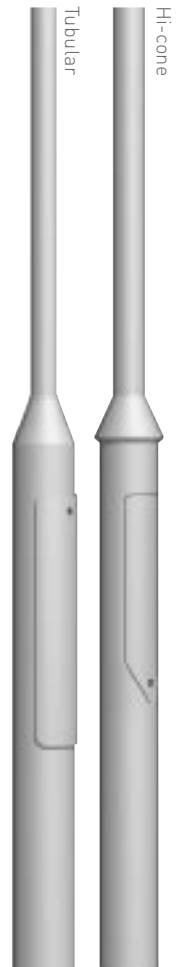

For flange plate add/FP: e.g. TB040/FP/HC1

- Accessories**
- ELSAB1/6A** Single phase, cut-out, 6A, termination plate
 - ELSAB12/6A** Single phase, twin cut-out, 6A

Columns and brackets finished hot dip galvanised to BSEN1461:1999
 Where indicated, columns are spray painted with a long life 2-pack acrylic coat, wet finish 190 microns. RAL9005 Black RAL9016 White.



Key features

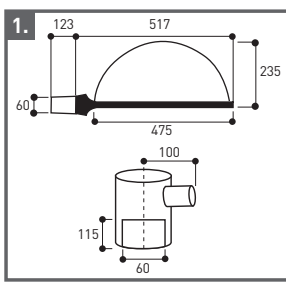

Dimensions & Mounting
 Mounting height: 4m-6m

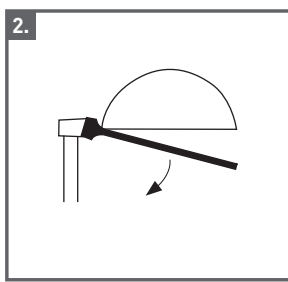

Maintenance
 Access the lamp and control gear by lowering glass via 3 releasing screw fixings

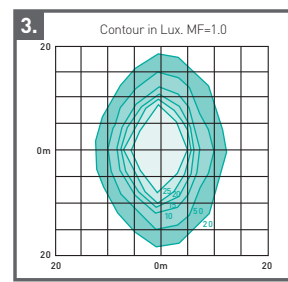

AM274
 150W SON-T
 Mounting height: 5m

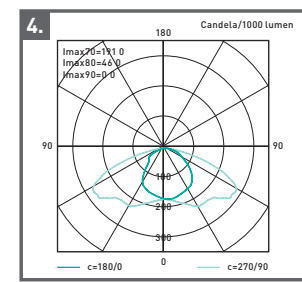

AM274
 150W SON-T
 Mounting height: 5m

All dimensions are in mm.

Full photometry available on our website www.abacuslighting.com