

AL63000 SERIES S-LUM Mini

IP66



Abacus®

Leaders in Lighting



Benefits:

- Tool-less quick access latch
- Screw-less maintenance
- Durable die-cast aluminium housing
- Flexibility with vertical or horizontal spigot mounting
- Multiple optics

Applications:

- Road
- Rail
- Pedestrian Areas
- Open area
- Amenity

Colour:

- Grey (RAL 7037)

An innovative road lighting luminaire of modular construction designed with ease of maintenance in mind. Tool-less upgrades of key components such as power supply and light engine along with field-replaceable LED modules ensure the luminaire takes full advantage of future improvements in LED technology.

With a lifetime of 100,000 hours (L80B10) combined with an efficacy of up to 159 lm/W, the AL63000 series keeps both operating and maintenance costs to an absolute minimum.

Key technical features:

- Controls; Dali, RF or PLC (specify at enquiry)
- Efficacy up to 159 lm/W
- Integrated 5 level dimming module (optional)
- Overheat protection
- Constant light output (optional)
- IP66 and IK09 rated
- Colour temperature 4000K as standard (3000K available)
- CRI ≥ 70 (80 optional)
- Power supply 220-240V
- Standard surge protection 6kV
- Operating temperature: -40°C to +55°C
- NEMA ready

Technical Specifications

Technical specification	
Lifetime L80B10	> 100,000 hours
Supply voltage	220Vac - 240Vac
System efficiency	152 lm/W
LED	4 - 8
Power (W)	10 - 30
Luminous flux (lm)	1390 - 4,580
Power factor	> 0.96
Colour Temperature (CCT)	4,000K as standard (other CCT available on request)
Factor of colour rendering (CRI)	≥ 70 (80 optional)
Mechanical strength	IK09
Protection class	IP66
Additional surge protection	10 kV / 6 kV; additional SPD 10kV / 10kA
Operating temperature	-40°C to +55°C
Electrical class	Class I (Class II optional)
Weight	4kg
Mounting	60mm or 76mm pole
Tilt	-10° to +15° (horizontal and vertical installation)
Certificates	IEC 60598-1:2014 (8th edition); IEC 60598-2-3:2002 + A1:2011; EN 60598 - 1:2015; EN 60598-2-3:2003 + A1:2011; IEC/EN 62031:2008 + A1 + A2; IEC/ TR 62778:2014; EN60068-2-6; N60068-2-27:CE, ENEC, LM79, IES LM-82-12
Guarantee	5 years on electronics, 10 years on mechanics, upon request
Remote control	Optional RF or PLC



AL63000 SERIES S-LUM Mini

Abacus®

Leaders in Lighting

Dimensions

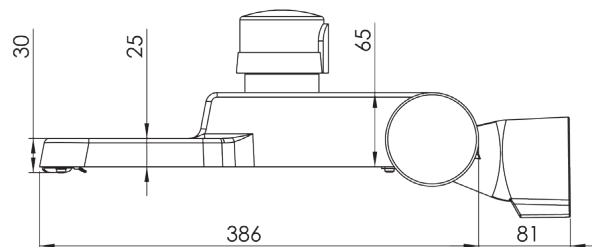
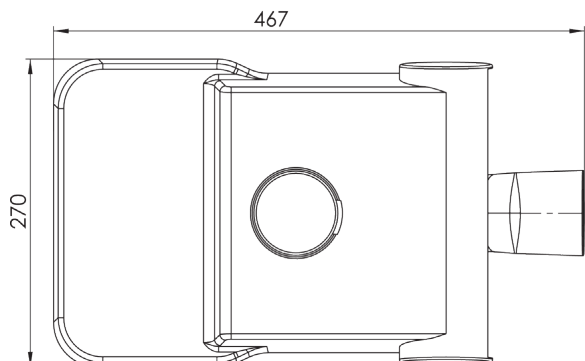

Photometric data

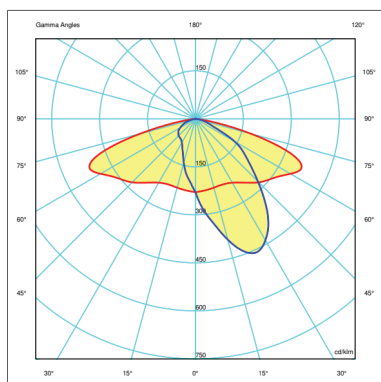

AL63002 - Suitable for narrower roadways, access roads, cycling and pedestrian areas.

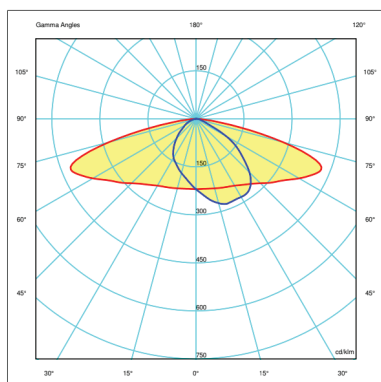

AL63009 - Suitable for wide roadways and long distances between poles.

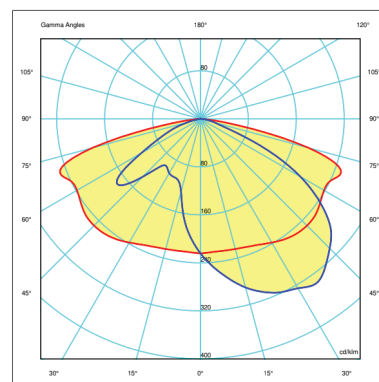

AL63012 - Suitable for wider roadways with large distances between poles.

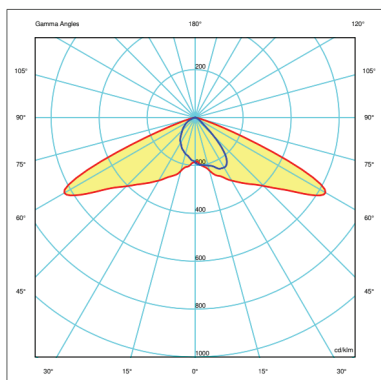

AL63013 - For wide roads with larger distances between columns.

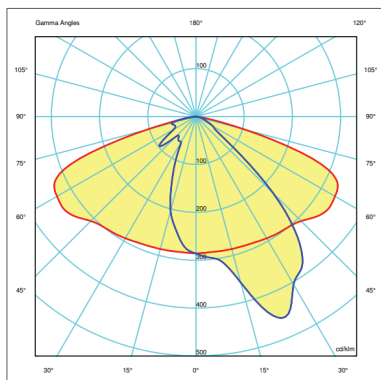

AL63014 - For wide roads, longer distances among columns



AL63000 SERIES

S-LUM Mini

Abacus®

Leaders in Lighting

Product selection

Beam Type Ref	Light distribution type	Luminaire wattage	4K CRI70 output
AL63002	(002) Suitable for narrower roadways, access roads, cycling and pedestrian areas	10	1590
		20	3181
		30	4579
AL63009	(220) Suitable for wide roadways and long distances between columns	10	1590
		20	3181
		30	4579
AL63012	(003) Suitable for wider roadways with large distances between columns	10	1590
		20	3181
		30	4579
AL63004	(020) Suitable for wide roads with larger distances between columns	10	1590
		20	3181
		30	4579
AL63014	(222) Suitable for wide roads with larger distances between columns	10	1590
		20	3181
		30	4579

Beam Type	Power (W)	Colour Temperature (CCT)	Accessories
AL630 02	10	4 = 4000K	PC = Photocell
AL630 09	20	3 = 3000K	PL = PLC NEMA node
AL630 12	30		RF = RF node
AL630 04			
AL630 14			

Example Product Selections:

